

Installation Instructions

Door Hanger

Hang your Jeep Doors safely with the Door Hanger. Read and follow the simple instructions for an easy installation. **If parts are missing or you need help, call Lange directly Toll-Free at 1-866-284-7428**

Tools Required

Drill
Hammer
Tape Measure/pencil
Stud Finder
7/32 Drill Bit
1/2 Wrench

Installation Steps

Review and make sure you are not missing any parts before installation *Fig. 1*. Locate a suitable site to hang the Door Hanger.

Suggestion: Mount the Hanger in a safe location so that other activities will not damage your doors.

There are only a few parts that need to be assembled. First locate the 1.25" End Caps *Item No. 7*, with your hammer gently tap them into the bottom of your Door Hanger Brackets *Fig. 1*. Second, find the 1" End Caps *Item No. 3* and gently tap them into the end of the 1" Bars *Item No. 2*. Note the 1" End Caps need to be on the opposite side of the spring buttons. Third, sleeve the foam *Item No. 4* over the 1" Bars until flush with the end caps. *If you have issues sleeving the foam over the bars, use some dish soap to lubricate if needed.*

After locating the approximate mounting spot, find two wall studs typically on 16" centers. Mark and test these studs for accurate position *Fig. 2*. If wall studs at 16" centers are not available, the Hangers may be mounted on a 2x6 that is cut to the span of your wall studs (2x6 not included).

With your wall marked, use the Curved Door Hanger Bracket *Item No. 1* as a guide to drill pilot holes using a 7/32 bit. After your pilot holes are drilled use the provided washers and lag bolts with a 1/2 wrench to secure the brackets to the wall; *do not over tighten to deform the tubing*. After your Door Hanger Brackets are secured install the foam bar with spring button. *Fig. 3*

Before removing your doors from the Jeep body make sure to roll down the windows. With the windows down fold in your side mirrors. Hang the first door with the mirror to the wall; then hang the second door with the mirror on the outside. Enjoy the Door Hanger.

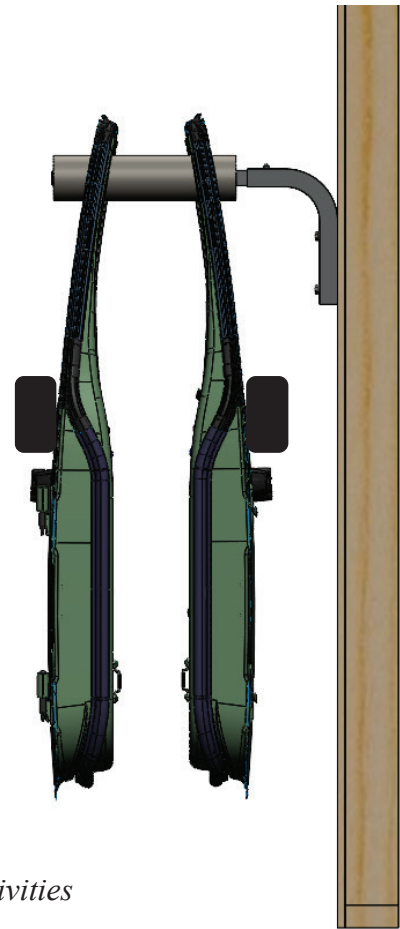

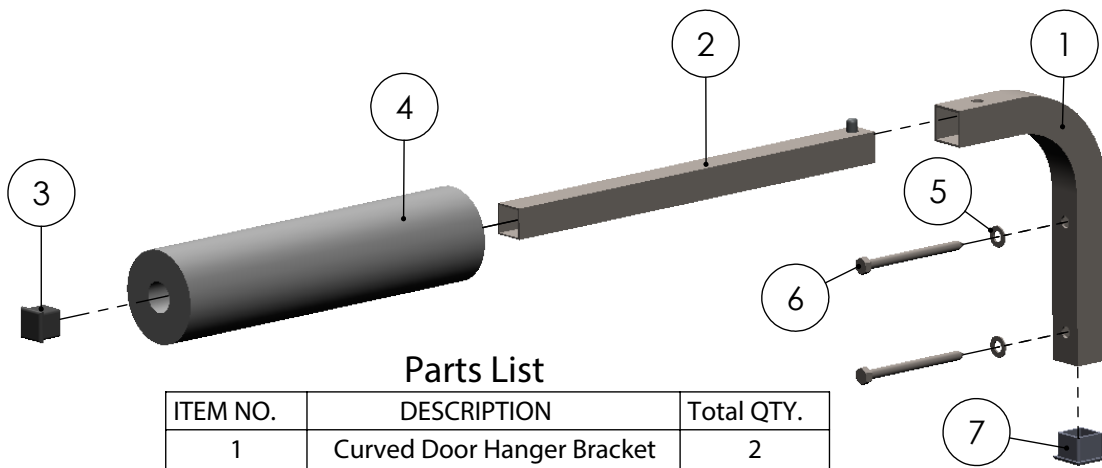

Parts List

ITEM NO.	DESCRIPTION	Total QTY.
1	Curved Door Hanger Bracket	2
2	1"square Bar with Spring Button	2
3	1" End Cap	2
4	12" foam piece	2
5	5/16" flat washer	4
6	5/16" x 4 Lag Bolt	4
7	1.25" End Cap	2

Fig.1

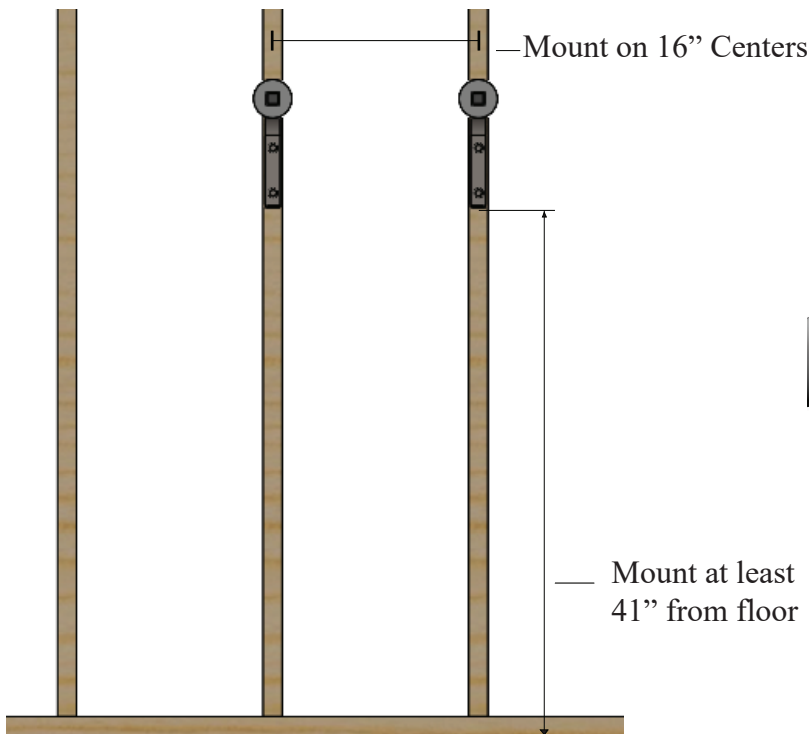

Fig.2

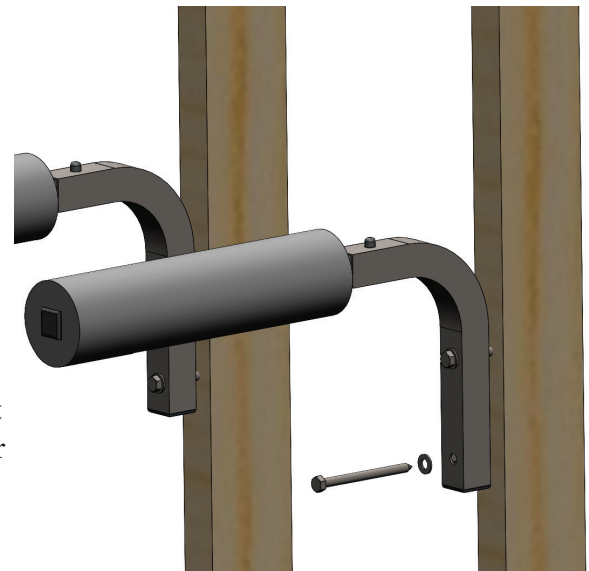

Fig. 3



3651 S 700 E
 Salt Lake City, UT 84106
 1-866-284-7428

Please visit our website www.LangeOriginals.com to view the compatible Freedom Panel Hanger (Part # 008-299) and other Lange Products.